

U-value

Date: 01.11.2024

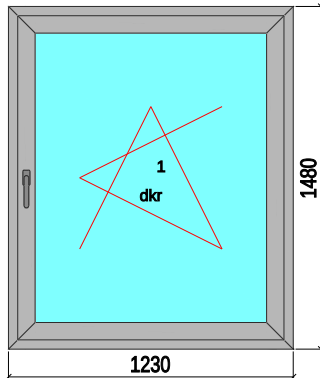

Construction with 1 element, 1230 mm x 1480 mm

[1] 1-part Window

Profile system: energeto neo MD
 Colour: ap white unlaminated
 Gasket: papyrus-white
 Frame: 160x05 Blendrahmen 73 mm (Reinforcements: 259107)
 Sash: 160x20 Sash 75 mm (Reinforcements: 269021)
 Fitting: 1x Tilt-and-turn right
 Handle: Window Consisting of:
 Fenstergriff
 Infill panel: ClimaGuard® Premium2 (CE) VSG33.1 UG 0.60 EU,
 150633 Glazing beads Qube-line

Size dependent calculation

[1] Window

U _w	U _{g,m}	U _{f,m}	ΣA _f	ΣA _g	ΣL _g	P _{sig,m}
W/(m ² K)	W/(m ² K)	W/(m ² K)	m ²	m ²	m	W/(mK)
0.86	0.60	1.1	0.57	1.25	4.5	0.040

Standard window calculation

[1] Window

U _w	U _{g,m}	U _{f,m}	ΣA _f	ΣA _g	ΣL _g	P _{sig,m}
W/(m ² K)	W/(m ² K)	W/(m ² K)	m ²	m ²	m	W/(mK)
0.86	0.60	1.1	0.57	1.25	4.5	0.040

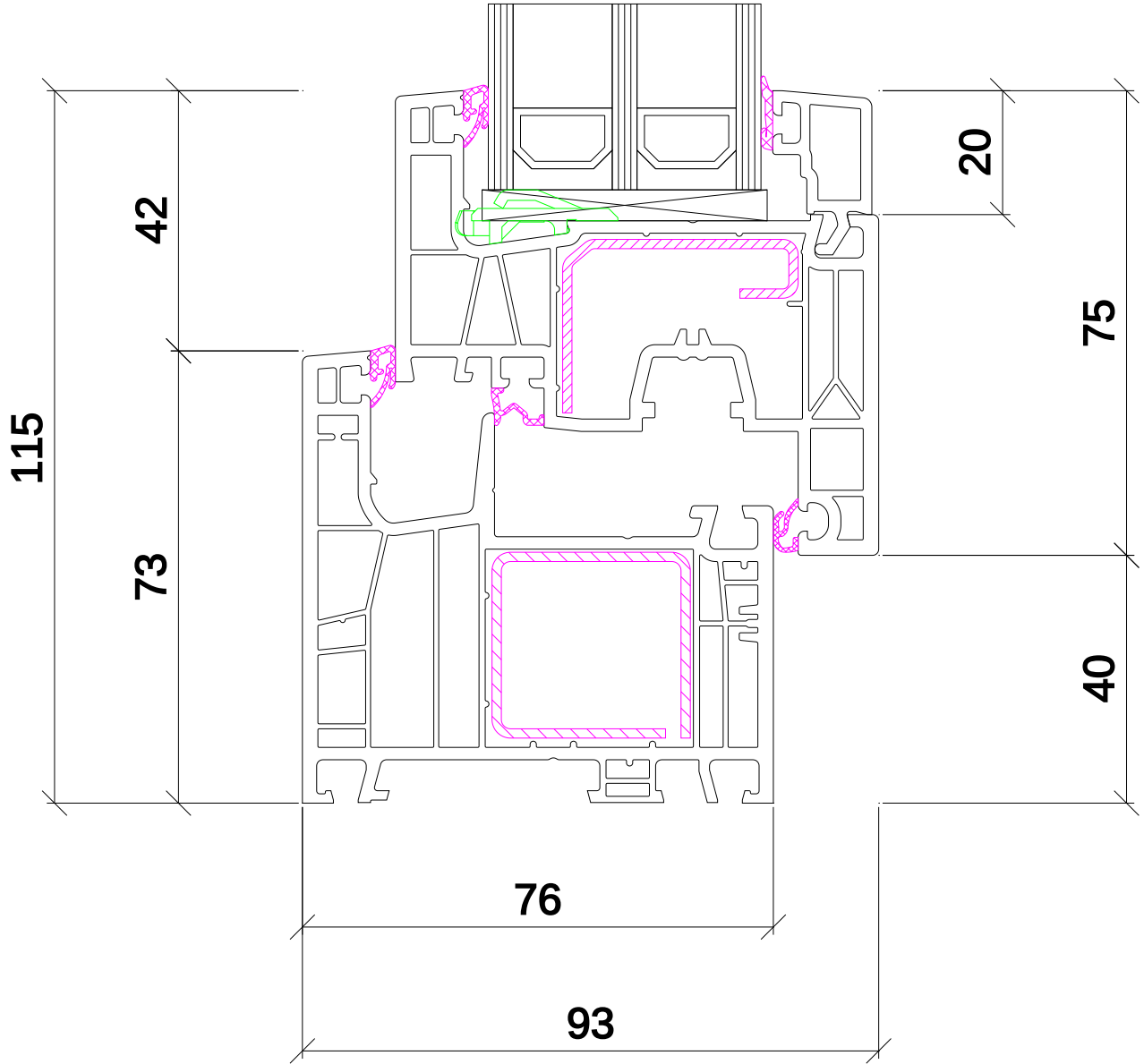

Europe

Make-up Name	Glass 1 & Coating	Glass 2 & Coating	Visible Light			Solar Energy				Thermal Properties	Embodied CO ₂ [eq. kg/m ²] A1-A3	Acoustic Values		
			Transmittance	Reflectance		Transmittance	Reflectance	Solar Factor (g%)	Secondary Heat Transfer (q _i)	U-Value U _g W/m ² ·K		RW(C;Ctr)	OITC	STC
				Visible (τ _v %)	ρ _v % out						ρ _v % in			
Make-up 01	Guardian ExtraClear (CE)	ClimaGuard® Premium2 (CE) on Guardian ExtraClear (CE)	72.8	15.6	15.6	42.9	27.6	50.0	7.1	0.6	46.97	40(-2;-5)	32	40

Calculation Standard: EN 410:2011 / EN 673:2011

Total Unit (Nominal):
44.762 mm

Glazing Weight:
38.8 kg/m²

Slope: 90°

Outdoors Indoors

Coatings

- S4 SURFACE 4 COATING ClimaGuard® Premium2 (CE)
- S7 SURFACE 7 COATING ClimaGuard® Premium2 (CE)

Important Notes

Calculations and terms in this report are based on EN 410:2011/EN 673:2011. The performance values shown above represent nominal values for the center of glass with no spacer system or framing. Solar Factor (g) and Secondary Heat Transfer (q_i) are not available for sloped glazing, as no calculation method is prescribed by the standard for these attributes.

The KIWA logo and KIWA Validation Report MD - 14/477/GL are provided as evidence of validation of the Guardian Performance Calculator software, program version 4.1, for execution of calculations of luminous and solar characteristics of glazing and thermal transmittance, according to EN 410:2011 and EN 673:2011.