

U-value

Date: 01.11.2024

Construction with 1 element, 3500 mm x 2200 mm

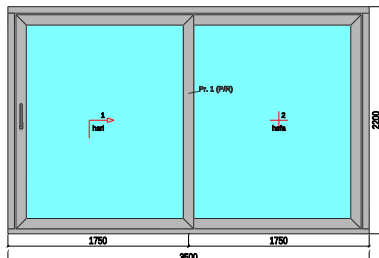

[1] 2-part Lift-and-slide door, Scheme A left

Profile system:	lift-slide
Colour:	ap white unlaminated
Gasket:	papyrus-white
Frame:	170080 Zargen 63 mm (left, right, top) (Reinforcements: 249228) 27726x Thresholds (bottom)
Sash:	170x81 Sash 100 mm (Field 1 bottom, left) (Reinforcements: 279036) 170x81 Sash 100 mm (Field 1 right, top, Field 2) (Reinforcements: 229125)
Fitting:	HST fixed outside (Field 2) HST Push right inside (Field 1)
Handle:	Lift-and-slide door Consisting of: Hebeschiebetür Griff
Infill panel:	ClimaGuard® Premium2 (CE) VSG33.1 UG 0.60 EU, 120633 Glazing beads Classic-line

Additional attached components:

Size dependent calculation

[1] Lift-and-slide door, Scheme A left

U _w	U _{g,m}	U _{f,m}	∑A _f	∑A _g	∑L _g	P _{sig,m}
W/(m ² K)	W/(m ² K)	W/(m ² K)	m ²	m ²	m	W/(mK)
0.84	0.60	1.3	2.00	5.70	13.584	0.040

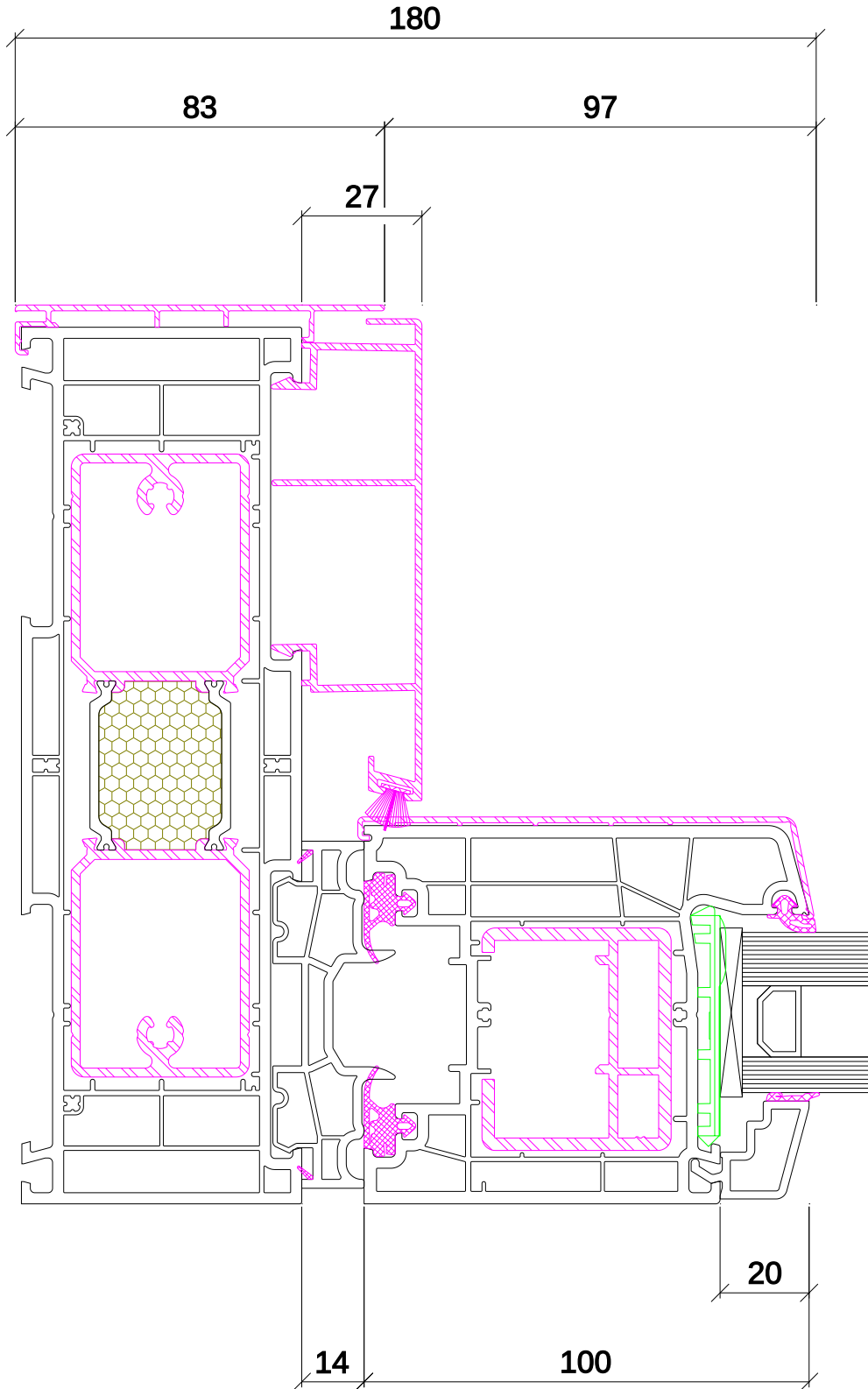

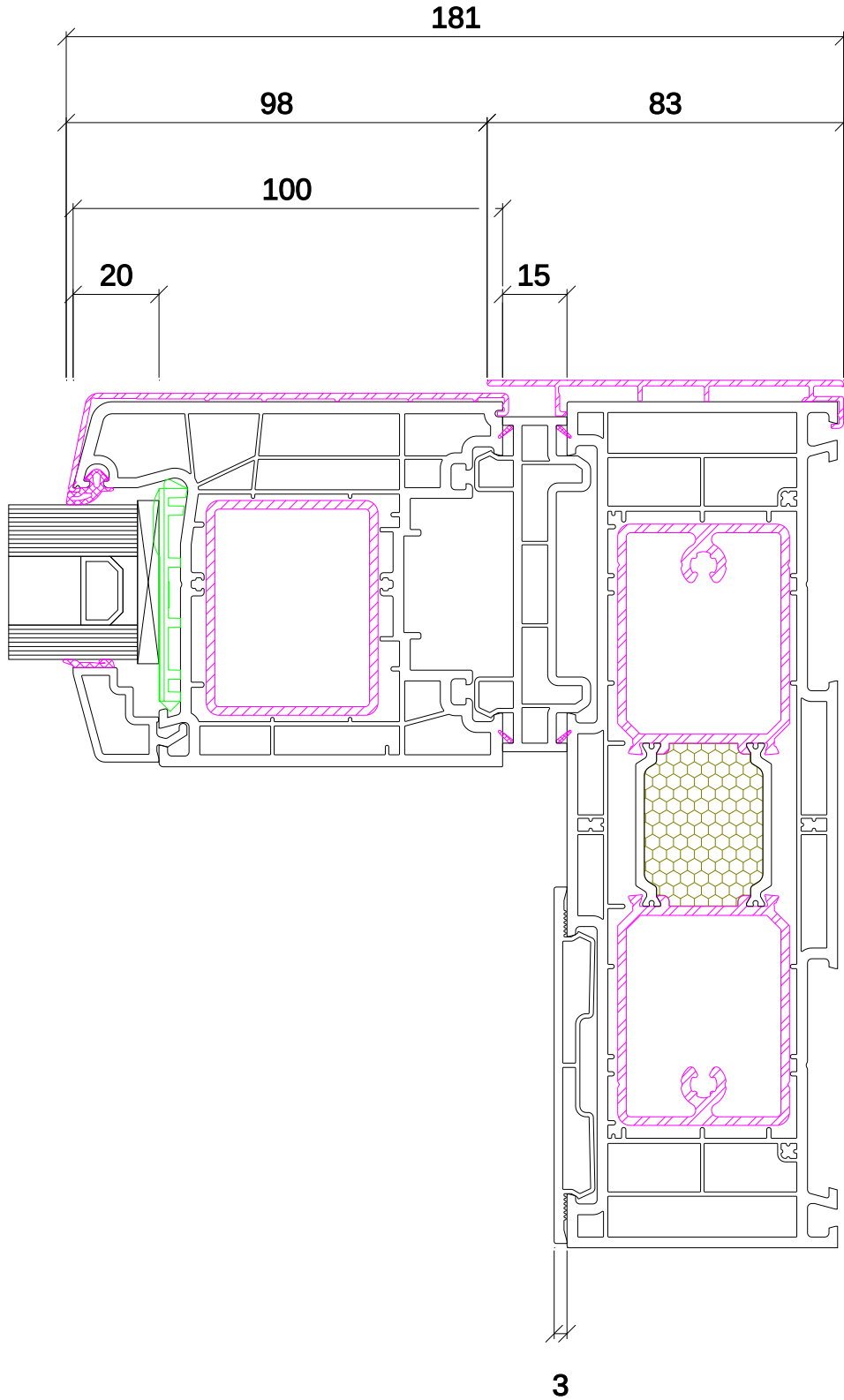

Europe

Make-up Name	Glass 1 & Coating	Glass 2 & Coating	Visible Light			Solar Energy				Thermal Properties	Embodied CO ₂	Acoustic Values		
			Transmittance	Reflectance		Transmittance	Reflectance	Solar Factor (g%)	Secondary Heat Transfer (q _i)	U-Value	[eq. kg/m ²] A1-A3	RW(C;Ctr)	OITC	STC
				Visible (τ _v %)	ρ _v % out									
EU	Guardian ExtraClear (CE)	ClimaGuard® Premium2 (CE) on Guardian ExtraClear (CE)	72.8	15.6	15.6	42.9	27.6	50.0	7.1	0.6	46.97	40(-2;-5)	32	40

Calculation Standard: EN 410:2011 / EN 673:2011

Total Unit (Nominal):
44.762 mm

Glazing Weight:
38.8 kg/m²

Slope: 90°

Outdoors

Indoors

Labels in diagram: GLASS 1 (3mm), INTERLAYER 1 (PVB Clear 0.38mm CE), GLASS 2 (3mm), GAP 1 (14mm, 10% Air, 90% Argon), GLASS 3 (4mm), GAP 2 (14mm, 10% Air, 90% Argon), GLASS 4 (3mm), INTERLAYER 2 (PVB Clear 0.38mm CE), GLASS 5 (3mm). Coating markers S4 and S7 are shown on the inner surfaces of Glass 2 and Glass 4 respectively.

Coatings

- S4 SURFACE 4 COATING ClimaGuard® Premium2 (CE)
- S7 SURFACE 7 COATING ClimaGuard® Premium2 (CE)

Important Notes

Calculations and terms in this report are based on EN 410:2011/EN 673:2011. The performance values shown above represent nominal values for the center of glass with no spacer system or framing. Solar Factor (g) and Secondary Heat Transfer (q_i) are not available for sloped glazing, as no calculation method is prescribed by the standard for these attributes.

The KIWA logo and KIWA Validation Report MD - 14/477/GL are provided as evidence of validation of the Guardian Performance Calculator software, program version 4.1, for execution of calculations of luminous and solar characteristics of glazing and thermal transmittance, according to EN 410:2011 and EN 673:2011.